

# ASSEMBLY INSTRUCTIONS

ITEM NO : B3200-1  
DRESSER

## BOX OF DRESSER

ITEM	DRAWING	DESCRIPTION	QTY
A		DRESSER	1
B		LEG (Packed underneath bottom panel )	4
C		SUPPORT LEG (Packed underneath bottom panel )	1

## BOX OF DRESSER HARDWARE LIST

ITEM	DRAWING	DESCRIPTION	QTY
1		JCBC SCREW (M6 x 50mm)	8
2		SPRING WASHER (M6)	8
3		FLAT WASHER (1/4)	8
4		ALLEN KEY (M4)	1

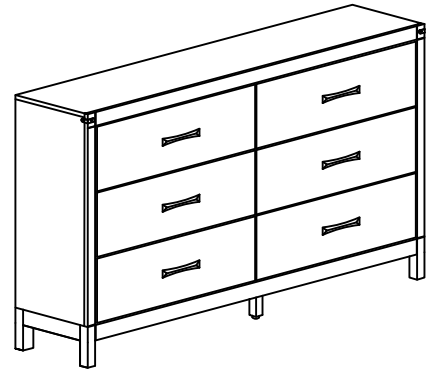

**COMPLETED DRESSER ASSEMBLY**

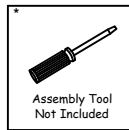

TIPPING RESTRAINT ( Affix to wall behind Dresser ) * Located in the Dresser 1st Drawer			
5	5a		BRACKET 2
	5b		TIE WRAP 1
	5c		LONG SCREW #8x2" L 1
	5d		SHORT SCREW #8x5/8" L 1

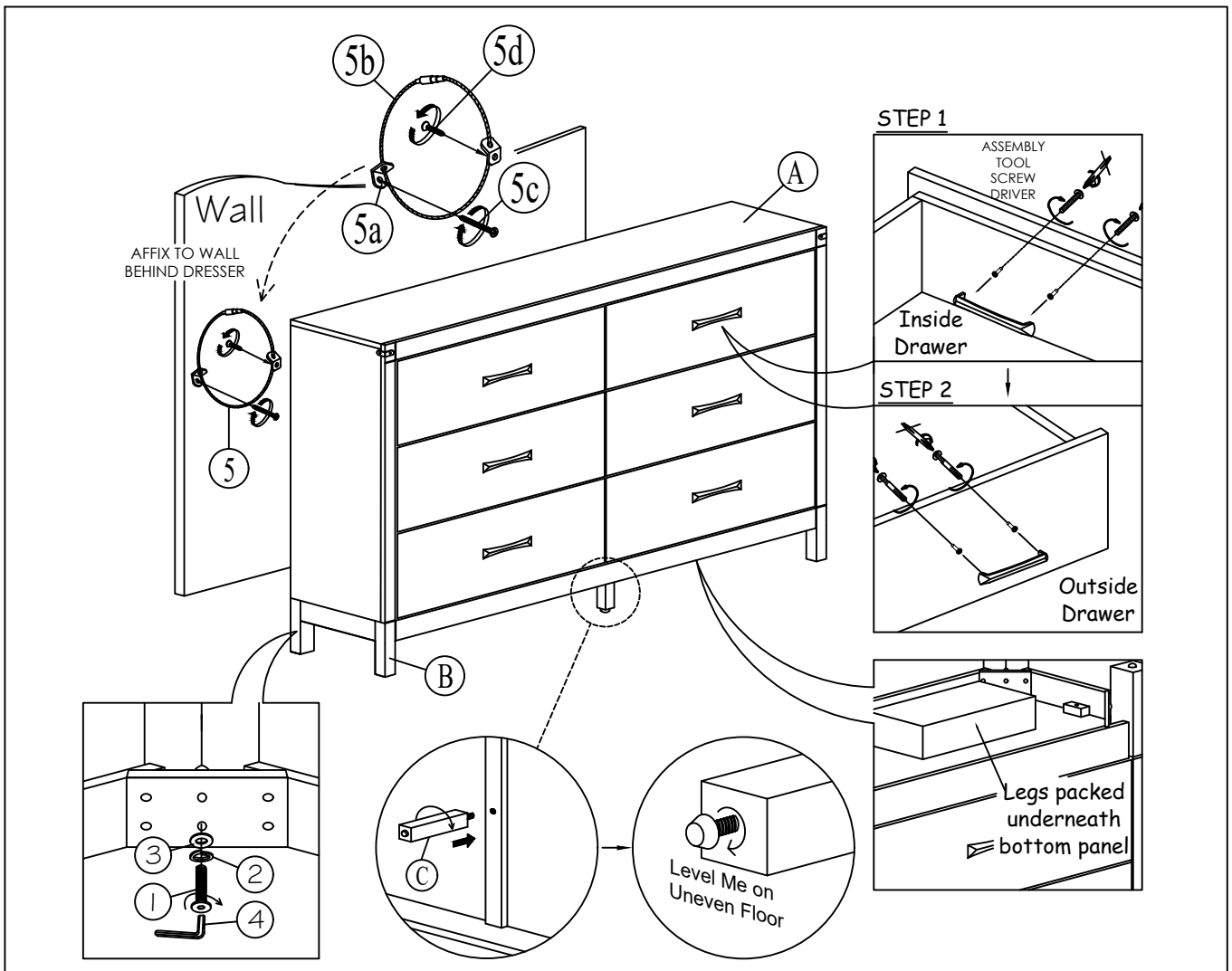

**THE HARDWARE IS LOCATED IN THE PACKING ITEMS**

**THE ANTI TIPPING HARDWARE IS LOCATED IN THE RIGHT SIDE FRONT DRAWER OF DRESSER**

NOTE : Periodically check to ensure that all connectors (bolts, screws, etc.) are tight.

## CLEANING INSTRUCTION

After assembled, clean & polish the completed parts if necessary with soft cloth and industrial recognized furniture polish

**MADE IN MALAYSIA**